



HIGH PERFORMANCE

SEALED VRLA MONOBLOC
AGM BATTERIES



HR-6230

VALVE REGULATED
LEAD ACID BATTERY

6V 800WATTS/CELL

@ 15MIN to 1.67 VPC

6V 230AH @ 10 HR to 1.80VPC

6V 262AH @ 20 HR to 1.75VPC

FOR APPLICATION:

UPS

SWITCHGEAR

INDUSTRIAL DC POWER

Innovative Features

- One-way relief valve, Explosion Resistant.
- Patented long life alloy having the lowest calcium levels industry-minimizing grid growth, reducing gassing, and extending battery life.

- 12 years design life in float applications @ 25°C(77°F).
- UL Recognized component.
- Valve regulated lead acid battery (VRLA).
- High-Compression Absorbed Glass Mat technology (AGM) for greater than 99% recombination efficiency.
- Proprietary Fixed Orifice Plate Pasting technology applying active materials on both sides of the grid for consistent cell-to-cell performance, higher capacity and uniform grid protection.
- Operates at a low internal pressure.
- Heavy duty threaded copper alloy terminals for ease of assembly, reduced maintenance and increased safety.
- Advanced lead tin calcium alloy, reduces grid corrosion and promotes long battery life.
- Over-sized, through the partition inter-cell welds provide low resistance connections, with minimal power loss.
- Flame arresting, low pressure safety release venting system for individual cells, recognized per U.L. 924.
- Horizontal or vertical operation.
- Multicell design for ease of installation and maintenance.
- Standard: Reinforced ABS (UL 94HB) container and cover
Optional: Flame-retardant reinforced ABS case and cover compliant with U.L.94 V-0 with an Oxygen Limiting Index of greater than 28%.

| 6 VOLTS - 800WATTS @ 15 MIN RATE | | | | | | | | | | |
|---|------|-------|-------|-------|-------|-------|-------|-------|-------|-------|
| Constant Power Discharging Ratings - Watts Per Cell @ 25°C (77°F) | | | | | | | | | | |
| End Point Volts/Cell | 5min | 10min | 15min | 20min | 30min | 40min | 45min | 50min | 60min | 90min |
| 1.67 | 1344 | 961 | 800 | 688 | 535 | 437 | 398 | 366 | 340 | 259 |

For UPS / Switchgear / Industrial DC Power

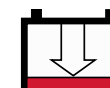
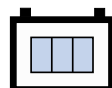

High Rate Range VRLA

EverExceed[®]
power your applications

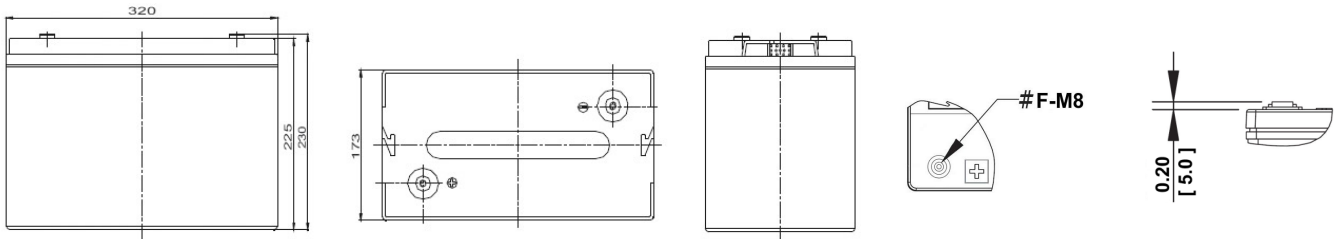

Length : 320mm Width : 173mm Height : 230mm

| Electrical Specifications | | | | | | |
|---------------------------|------------------|----------------|-------------|---------------------------|-----------------------|---------------------|
| Cells Per Unit | Voltage Per Unit | Weight | Electrolyte | Maximum Discharge Current | Short Circuit Current | Ohms Imped 60 Hz(Ω) |
| 3 | 6.42 | 70.6lbs 32.0kg | SG = 1.300 | 1495Amps | 6300 Amps | 0.0015 |

| | |
|--|---|
| Capacity | 800Watts per all at the 15 minute rate to 1.67 volts per cell at 25°C (77°F). 230Ah @ 10 hr. rate to 1.80 volts per cell @ 25°C (77°F). 262Ah @ 20 hr. rate to 1.75 volts per cell @ 25°C (77°F). |
| Applicable Operating Temperature Range | -40°F (-40°C) to +158°F (70°C). |
| Ideal Operating Temperature Range | +68°F (+20°C) to +82.4°F (28°C). |
| Floating Charging Voltage | 6.75 to 6.90 VDC/unit Average at 25°C (77°F). |
| Recommended Maximum Charging Current Limit | C/5 amperes (52.4 amperes @ 100% depth of discharge) @ 20 hr. rate to 1.75VPC. |
| Equalization and Cycle Service Charging Voltage | 7.20 to 7.40 VDC/unit Average at 25°C (77°F). |
| Maximum AC Ripple (Charger) | 0.5% RMS or 1.5% P-P of float charge voltage recommended for best results. Maximum voltage allowed = 1.4% RMS (4% P-P). Maximum current allowed = 13.2 amperes RMS (C/20) to 1.75VPC. |
| Self Discharge | EverExceed High Rate Range batteries may be stored for up to 12 months at 25°C (77°F) and then a freshening charge is required. For higher temperatures the time interval will be shorter. |
| Accessories | Inter unit connectors racks and cabinet systems are available. |
| Terminal: Inserted | Threaded copper alloy insert terminal |
| Terminal Hardware Initial Torque: Inserted Terminal | 11 N-m |

| Constant Power Discharging Ratings - Watts Per Cell @ 25°C (77°F) | | | | | | | | | | |
|---|------|-------|-------|-------|-------|-------|-------|-------|-------|-------|
| End Point Volts/Cell | 5min | 10min | 15min | 20min | 30min | 40min | 45min | 50min | 60min | 90min |
| 1.75 | 1251 | 921 | 728 | 639 | 495 | 400 | 374 | 340 | 317 | 237 |
| 1.70 | 1326 | 949 | 776 | 667 | 520 | 424 | 391 | 357 | 332 | 250 |
| 1.67 | 1344 | 961 | 800 | 688 | 535 | 437 | 398 | 366 | 340 | 259 |

| Constant Current Discharging Ratings - Ampere Per Cell @ 25°C (77°F) | | | | | | | | | | |
|--|-----|------|------|------|------|------|------|------|------|------|
| End Point Volts/Cell | 1hr | 2hr | 3hr | 5hr | 8hr | 10hr | 12hr | 20hr | 24hr | 72hr |
| 1.85 | 144 | 82.0 | 59.5 | 39.2 | 26.6 | 22.1 | 19.0 | 12.2 | 10.2 | 3.57 |
| 1.80 | 156 | 88.9 | 63.1 | 41.3 | 27.8 | 23.0 | 19.9 | 12.8 | 10.7 | 3.70 |
| 1.75 | 161 | 91.1 | 65.5 | 42.4 | 28.9 | 23.9 | 20.4 | 13.2 | 11.1 | 3.78 |

Note: Batteries to be mounted with 0.39 in (1.00 cm) spacing minimum and free air ventilation.
Specifications subject to change without notification.

